

Stealth Products
®

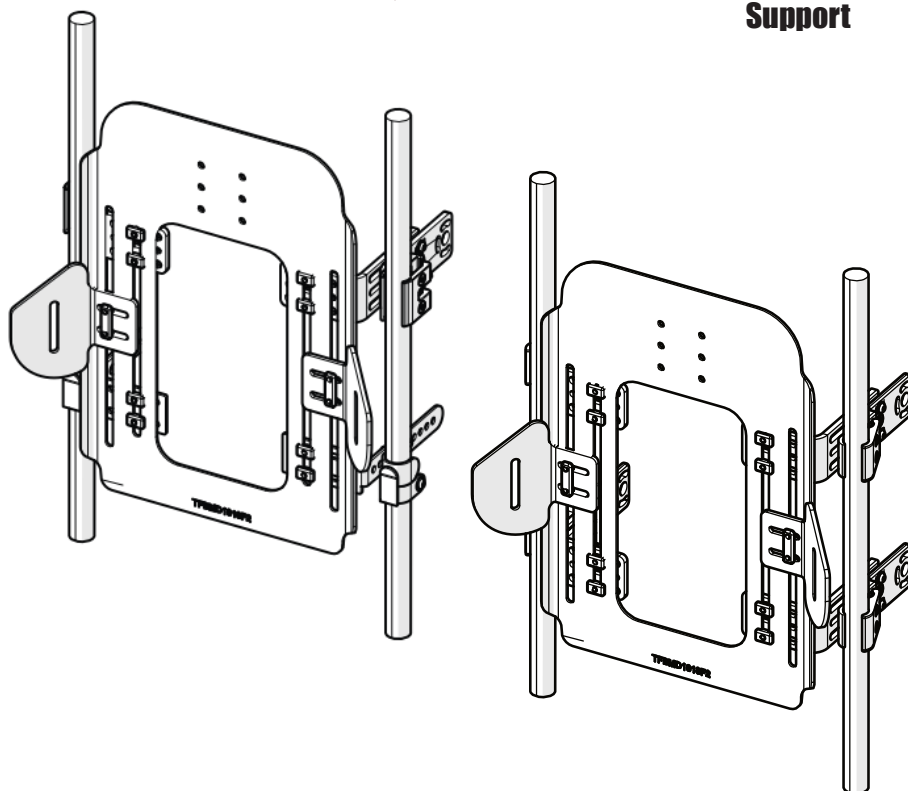

**Backs &
Support**



TFB

Flex

Owner's Manual - Maintenance Guide

True Forming Back - Flex Back Shells



Table of Contents

Customer Satisfaction	i
General.....	i
Important Information	ii-iii
Warranty.....	ii
Supplier Reference	ii
Warning Labels	iii
Limited Liability.....	iii
Testing	iii
Design and Function	1-2
Intended Use	1
Features	1
Mounting	1
Parts and Accessories Breakdown	2
Configurations	2
Installation Instructions	7-12
2-point Fixed Installation	7
2-point Removable Installation	8
4-point Fixed Installation	9
4-point Removable Installation	10
4-point Heavy Duty Installation	11
Installing Wings and Laterals	12
Adjustment of Mounting Hardware	12
Adjustment of Wings and Laterals.....	12
First Time Use	13
Dealer Assistance	13
User Testing.....	13
Conditions of Use	13
Maintenance	14
Cleaning.....	14
Disinfection	14
Maintenance	14

Stealth Products is committed to 100% customer satisfaction. Your complete satisfaction is important to us. Please contact us with feedback or suggestions to help us improve the quality and usability of our products.

You may reach us at:



Stealth Products, LLC

104 John Kelly Drive
Burnet, TX 78611

Phone: (512) 715-9995 Toll Free: (800) 965-9229

Fax: (512) 715-9954 Toll Free: (800) 806-1225

info@stealthproducts.com
www.stealthproducts.com



MDSS GmbH
Schiffgraben 41
30175 Hannover, Germany

General

Read and understand all instructions prior to the use of this product. Failure to adhere to instructions and warnings in this document may result in property damage, injury, or death. Product misuse or failure to follow instructions will void the warranty.

Immediately discontinue use if any function is compromised, if parts are missing or loose, or if any component shows signs of excessive wear. Consult with your supplier for repair, adjustment, or replacement.

All persons responsible for fitting, adjustment, and daily use of the devices discussed in these instructions must be familiar with and understand all instructions and warnings, and maintain our products according to our instructions on care and maintenance. The installation instructions will guide you through this products' options and possibilities.

Instructions are written with the expressed intent of use with standard configurations. They also contain important safety and maintenance information, as well as describe possible problems that can arise during use. For further assistance, or more advanced applications, please contact your supplier or Stealth Products at (512) 715-9995 or toll free at (800) 965-9229.

Always keep the operating instructions in a safe place so they may be referenced as necessary.

All information, pictures, illustrations, and specifications are based on the product information that was available at the time of printing. Pictures and illustrations shown in these instructions are representative examples and are not intended to be exact descriptions of the various parts of the product.

Important Information

CAUTION

These products are designed to be fitted, applied, and installed exclusively by a healthcare professional trained for these purposes. The fitting, application, and installation by a non-qualified individual could result in serious injury.

Warranty

Our products are designed, manufactured, and produced to the highest of standards. If any defect in material and workmanship is found, **Stealth Products** will repair or replace the product at our discretion. Any implied warranty, including the implied warranties of merchantability and fitness for a particular purpose, shall not extend beyond the duration of this warranty. **Stealth Products** does not warrant damage due to, but not limited to: misuse, abuse, or misapplication of product, and/or modification of product without written approval from **Stealth Products, LLC**. Any alteration or lack of serial number, where applicable, will automatically void all warranty.

Stealth Products, LLC is liable for replacement parts only. **Stealth Products, LLC** is not liable for any incurred labor costs.

Stealth Products warrants against failure due to defective materials or workmanship:

Covers: 2 years

Hardware: 5 years

Electronics: 3 years

In the event of a product failure covered by our warranty, please follow the procedures outlined below:

Call **Stealth Products** at (512) 715-9995 or toll free at (800) 965-9229.

Request a Return Authorization (RA) form from the Returns Department and follow the documentation instructions.

You can download additional copies of this manual by accessing the Stealth website (<https://stlpro.site/stealth-docs>) and searching "P136D690" in the search bar at the top of the page.

Supplier Reference

Supplier:	
Telephone:	
Address:	
Purchase Date:	
Model:	

Warning Labels

Warnings are included for the safety of the user, client, operator, and property. Please read and understand what the signal words **DANGER**, **WARNING**, **CAUTION**, **NOTICE**, and **SAFETY** mean, and how they could affect the user, those around the user, and property.



DANGER

Identifies an **imminent** situation which, if not avoided, may result in **severe injury, death, and property damage**.



WARNING

Identifies a **potential** situation which, if not avoided, may result in **severe injury, death, and property damage**.



CAUTION

Identifies a **potential** situation which, if not avoided, may result in **minor to moderate injury and property damage**.

NOTICE

Identifies important information not related to injury, but possible **property damage**.

SAFETY

Indicates steps or instructions for safe practices, reminders of safe procedures, or important safety equipment that may be necessary.

Limited Liability

Stealth Products, LLC accepts no liability for personal injury or damage to property that may arise from the failure of the user or other persons to follow the recommendations, warnings, and instructions in this manual.

Stealth Products does not hold responsibility for final integration of final assembly of product to end user. Stealth Products is not liable for user death or injury.

Testing

Initial setup and driving should be done in an open area free of obstacles until the user is fully capable of driving safely.

Intended Use

The True Forming Back, or TFB, has been created to provide extreme comfort, unparalleled customizable options, and trouble-free adjustability. The hardware is durable, easily accessible, and is hidden with a hook-and-loop attached back for a clean, sleek look.

The rigid aluminum shell, coupled with a double layer of soft, supportive foam and supple cover material, provides an optimal surface to match the contours of the user's back and upper torso. This helps to maintain proper positioning of the pelvis, back, and torso.

Features

The Flex back features:

- Adjustable depth and width;
- Angle adjustment with no loss of seat depth;
- Compatibility with push-button swing-away laterals to ease transfers to and from the chair;
- Smooth, finished edges on all parts; and,
- A wide range of adjustability to meet the needs of nearly any client.

Mounting

The True Forming Back mounting hardware and Flex shell can be installed on virtually any chair utilizing back post canes or tubes. Flex can be configured as fixed or removable, and provides width, angle, and depth adjustment, as needed. Flex can accommodate many types of positioning belt systems and multiple types of headrests, including the TWB480, UniLink, and HMO Series.

NOTICE

Altering the **True Forming Back** mounting hardware or **Flex** shell in any way, and/or an improper installation will void the warranty

SAFETY

Always check all mounting hardware, ensuring each fastener is properly tightened prior to using the **True Forming Back**.



WARNING

User weight limit: 250 lbs. (113.40kg)

Parts and Accessories Breakdown

A typical **True Forming Back (TFB)** package contains the following parts:

1. Back

Composed of a rigid aluminum shell with a dual layer of soft, supportive foam and a supple cover made of materials such as Neoprene, Airmesh, or Coolcore. A foam-in-place option is also available.

2. Mounting Hardware

The mounting hardware for your back was installed at the factory. It provides a fixed or removable set of mounting points to securely affix the back to the canes of your chair.

3. Wings or Laterals (*optional*)

Depending on need, wings or laterals are utilized to provide thoracic or upper torso support.

SAFETY

Always check all mounting hardware, ensuring each fastener is properly tightened prior to using the **True Forming Back**.

Configurations

TFB Flex back shells can be installed in several different configurations. Please choose the set of instructions on the following pages that matches your mounting hardware configuration.

Mounting Hardware			
	Fixed	Removable	Heavy Duty
<i>Top</i> 2-point	Simple Solutions Stability Hardware	FlipLock Hardware	N/A
<i>Bottom</i>	N/A	N/A	N/A
<i>Top</i> 4-point	Simple Solutions Stability Hardware	FlipLock Hardware	Simple Solutions Stability Hardware
<i>Bottom</i>	J&L Hardware	J&L Hardware	Simple Solutions Stability Hardware

Installation

2-point Fixed Installation:

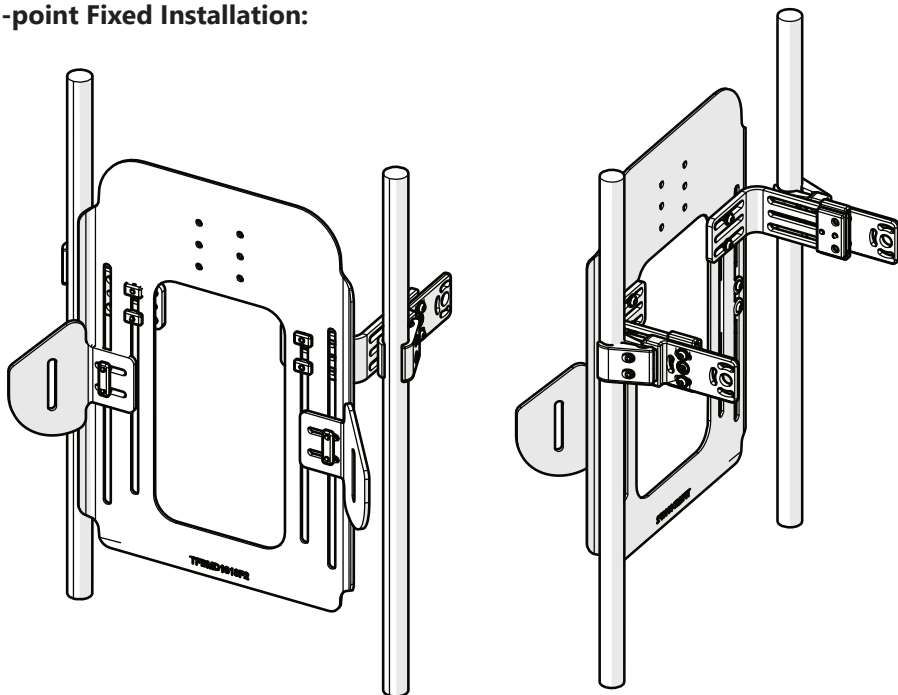

1. Install the **Simple Solutions Stability** hardware to the back shell. See page 3, "*Mounting the Hardware to the Back Shell*", in the TFB Simple Solutions Fixed Hardware Manual.
2. Adjust the **Simple Solutions Stability** hardware for width to fit the back posts. See page 6, "*Adjustments*" section, in the TFB Simple Solutions Fixed Hardware Manual.
3. Install the **Simple Solutions Stability** hardware to the back posts. See page 4, "*Mounting the Hardware to the Back Posts*", in the TFB Simple Solutions Fixed Hardware Manual.
4. Adjust the height, depth, and angle of the back shell. See page 6, "*Adjustments*" in the TFB Simple Solutions Fixed Hardware Manual.
5. When adjustments are complete, tighten all fasteners to secure the back to the chair.
6. Install support wings or thoracic laterals to the back shell, if required, as described later in this section.
7. Install headrest mounting hardware and seat-to-back hinge or bracket hardware, if required, into the pre-drilled holes in the back shell, according to the instructions in the manual(s) included with that mounting hardware.

2-point Removable Installation:

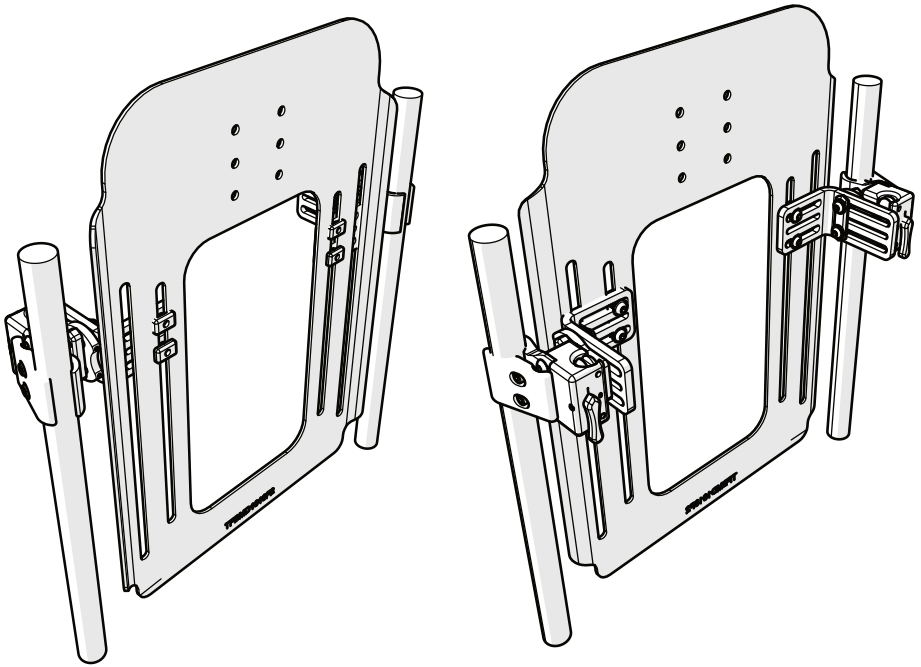

1. Install the **Fliplock** hardware to the back shell. See page 3, "*Mounting the Hardware to the Back Shell*" in the TFB Simple Solutions Removable Hardware Manual.
2. Adjust the **Fliplock** hardware for width to fit the back posts. See page 6, "*Adjustments*" in the TFB Simple Solutions Removable Hardware Manual.
3. Install the **Fliplock** hardware to the back posts. See page 4 and 5, "*Mounting the Hardware to the Back Posts*" in the TFB Simple Solutions Removable Hardware Manual.
4. Adjust the height, depth, and angle of the back shell. See page 6, "*Adjustments*" in the TFB Simple Solutions Removable Hardware Manual.
5. When adjustments are complete, tighten all fasteners to secure the back to the chair.
6. Install support wings or thoracic laterals to the back shell, if required, as described later in this section.
7. If required, install headrest mounting hardware and seat-to-back hinge or bracket hardware into the pre-drilled holes in the back shell, according to the instructions in the manual(s) included with that mounting hardware.

4-point Fixed Installation:

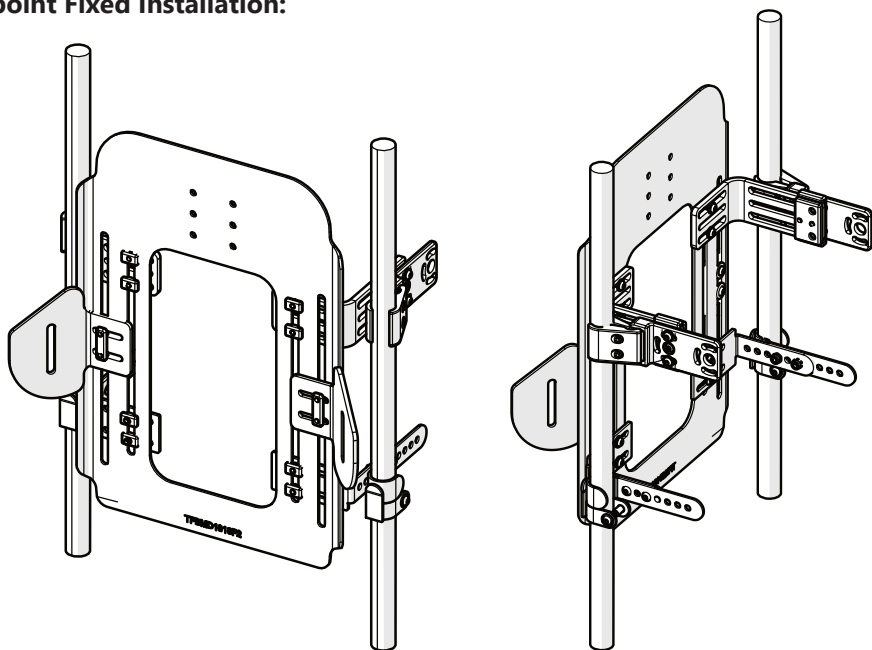

1. 4-point fixed installation requires the **Simple Solutions Stability** hardware mounted in the upper position of the back shell, and the **J&L** hardware in the lower position. Install the hardware in these positions. See page 3, *"Mounting the Hardware to the Back Shell"*, and page 5, *"Mounting the J&L Hardware"* in the TFB Simple Solutions Fixed Hardware Manual.
2. Adjust the **Simple Solutions Stability** hardware and the **J&L** hardware for width to fit the back posts. See page 6, *"Adjustments"* in the TFB Simple Solutions Fixed Hardware Manual.
3. Install the **Simple Solutions Stability** hardware and the **J&L** hardware to the back posts. See page 4, *"Mounting the Hardware to the Back Posts"* in the TFB Simple Solutions Fixed Hardware Manual.
4. Adjust the height, depth, and angle of the back shell. See page 6, *"Adjustments"* in the TFB Simple Solutions Removable Hardware Manual.
5. When adjustments are complete, tighten all fasteners to secure the back to the chair.
6. Install support wings or thoracic laterals to the back shell, if required, as described later in this section.
7. Install headrest mounting hardware and seat-to-back hinge or bracket hardware, if required, into the pre-drilled holes in the back shell, according to the instructions in the manual(s) included with the mounting hardware.

4-point Removable Installation:

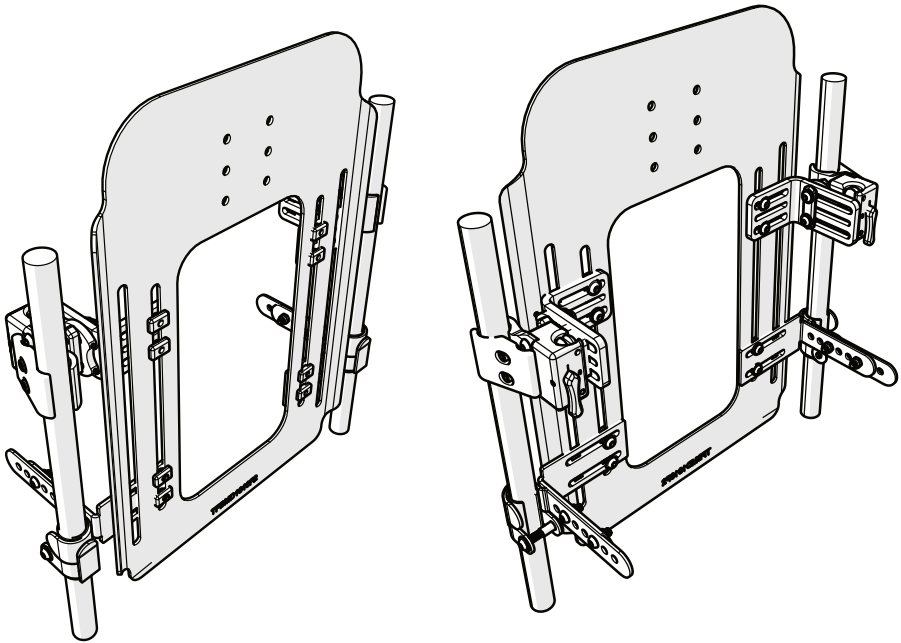

1. 4-point removable installation requires the **FlipLock** hardware in the upper position of the back shell, and the **J&L** hardware in the lower position. Install the hardware in these positions. See page 3, "*Mounting the Hardware to the Back Shell*" and page 5, "*Mounting the J&L Hardware*" in the TFB Simple Solutions Removable Hardware Manual.
2. Adjust the **FlipLock** hardware and the **J&L** hardware for width to fit the back posts. See page 6, "*Adjustments*", in the TFB Simple Solutions Removable Hardware Manual.
3. Install the **FlipLock** hardware and the **J&L** hardware to the back posts. See page 4, "*Mounting the Hardware to the Back Posts*" in the TFB Simple Solutions Removable Hardware Manual.
4. Adjust the height, depth, and angle of the back shell. See page 6, "*Adjustments*", in the TFB Simple Solutions Removable Hardware Manual.
5. When adjustments are complete, tighten all fasteners to secure the back to the chair.
6. Install support wings or thoracic laterals to the back shell, if required, as described later in this section.
7. If required, install headrest mounting hardware and seat-to-back hinge or bracket hardware into the pre-drilled holes in the back shell, according to the instructions in the manual(s) included with the mounting hardware.

4-point Heavy Duty Installation:

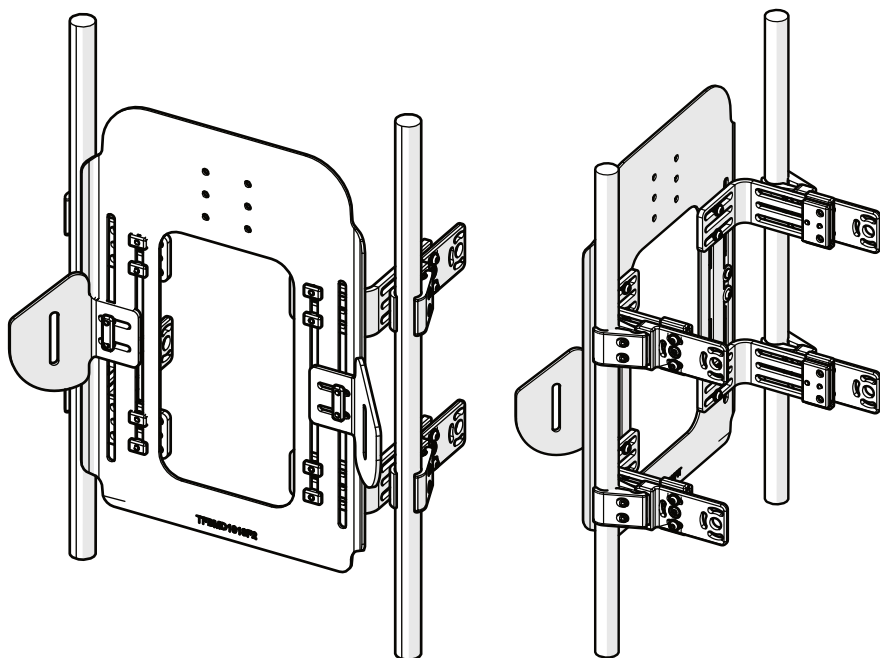

1. 4-point Heavy Duty installation utilizes the **Simple Solutions Stability** hardware in both the upper and lower positions on the back shell. Install the hardware in these positions. See page 3, "*Mounting the Hardware to the Back Shell*" in the TFB Simple Solutions Fixed Hardware Manual.
2. Adjust the **Simple Solutions Stability** hardware for width to fit the back posts. See page 6, "*Adjustments*", in the TFB Simple Solutions Fixed Hardware Manual.
3. Install the **Simple Solutions Stability** hardware to the back posts. See page 4, "*Mounting the Hardware to the Back Posts*", in the TFB Simple Solutions Fixed Hardware Manual.
4. Adjust the height, depth, and angle of the back shell. See page 6, "*Adjustments*", in the TFB Simple Solutions Fixed Hardware Manual.
5. When adjustments are complete, tighten all fasteners to secure the back to the chair.
6. Install support wings or thoracic laterals to the back shell, if required, as described later in this section.
7. If required, install headrest mounting hardware and seat-to-back hinge or bracket hardware into the pre-drilled holes in the back shell, according to the instructions in the manual(s) included with the mounting hardware.

Installing Wings and Laterals

1. Align the holes in the wing or lateral bracket with the vertical slots near the outer edges of the back shell.
2. Insert the stud plate or screws through the lateral or wing, and then through the corresponding slot in the back shell. Thread the washers and lock nuts onto the fasteners.
3. Move the wing or lateral bracket to the desired position on the back shell and tighten the lock nuts to secure it.
4. Consult the manual that shipped with your lateral hardware for further details.

Adjustment of Mounting Hardware

Adjustment instructions specific to your mounting hardware can be found in the "Adjustments" section in the mounting hardware manual included with your kit.

Adjustment of Wings and Laterals

1. Loosen the screws securing the wing or lateral to the back shell.
2. Slide the lateral up or down in the slot to the desired position and angle.
3. Tighten the screws to secure the wing or lateral in position.
4. Refer to the manual included with the laterals for more specific adjustment information.

Dealer Assistance

During first-time use by the client, it is advised that the dealer or service technician assists and explains the set-up to the customer (the user and/or the attendant). If needed, the dealer may make final adjustments.

User Testing

It is important that the customer is fully aware of the installation, how to use it, and what can be adjusted in order to gain as much mobility as possible. As a dealer, proceed as follows:

- Explain and show the customer how you have executed the installation, and explain the function.

Have the user test the position of the TFB Flex.

Is the hardware in the proper position for the client?

- Can the user safely operate all controls with minimal effort?
- If needed, make any adjustments to the positioning.

Explain to the customer possible problems and how to address them.

Conditions of Use

The TFB Flex is intended for use as installed by the dealer, in accordance with the installation instructions in this manual.

- The foreseen conditions of use are communicated by the dealer or service technician to the user and/or attendant during the first-time use.
- If the usage conditions change significantly, please contact your dealer or a qualified service technician to avoid excessive wear and tear or unintended damage.

Cleaning

- Use a soft cloth to clean the back shell.
- Ensure all cleaners are approved for finished steel, aluminum, plastic, and upholstered surfaces.
- Hand wash the foam pad cover with mild, soapy water or detergent, rinse well, and let dry.
- Foam pad should NOT get wet.
- A brush with soap and water can be used to remove any dirt and debris that may become lodged in the zipper teeth.

To wash the covers of the laterals:

- Remove the pad/cover from the lateral; and,
- Machine wash in cold water on delicate cycle and drip dry.

Disinfection

- Wipe gently with a cloth dampened with a household disinfectant.
- Allow foam to air dry thoroughly.

Maintenance

These care and guideline instructions will keep the hardware and covers in good condition for a longer period of time and prevent damage.

- Check and tighten all fasteners on a regular basis. Do not overtighten the fasteners.
- Check pad/covers for any breakdown.
- Repair or replace parts as needed.
- Gently remove dust and dirt from hardware with a damp cloth as necessary.



© 2022, Stealth Products, LLC

Warranty Information



Home Page



Online User Manual



Stealth Products, LLC · info@stealthproducts.com · www.stealthproducts.com
(800) 965-9229 | (512) 715-9995 | 104 John Kelly Drive, Burnet, TX 78611