



USER MANUAL

Stealth Products

Positioning & Support



SUS9 Swing Away Series

Stealth's User Manual and Maintenance Guide for
the SUS9 Swing Away Series

Stealth Products strives for 100% customer satisfaction. Your complete satisfaction is important. Please contact us with feedback or suggested changes that will help improve the quality and usability of our products.

You may reach us at:



Stealth Products, LLC

104 John Kelly Drive, Burnet, TX 78611

Phone: (512) 715-9995

Toll Free: 1(800) 965-9229

Fax: (512) 715-9954

Toll Free: 1(800) 806-1225

info@stealthproducts.com

www.stealthproducts.com



MDSS GmbH

Schiffgraben 41

30175 Hannover, Germany



General

Read and understand all instructions prior to the use of the product. Failure to adhere to instructions and warnings in this document may result in property damage, injury, or death. Product misuse due to failure of the following instructions will void the warranty.

Immediately discontinue use if any function is compromised, parts are missing, loose, or shows signs of excessive wear. Consult with your supplier for repair, adjustment, or replacement.

Important Information!

All persons responsible for fitting, adjustment, and daily use of the devices discussed in these instructions must be familiar with and understand all safety aspects of the devices mentioned. In order for our products to be used successfully, you must:

- Read and understand all instructions and warnings.
- Maintain our products according to our instructions on care and maintenance.
- Devices should be installed and adjusted by a trained technician.

Supplier Reference

Supplier: _____

Telephone: _____

Address: _____

Purchase Date: _____

Model: _____

Before you install or begin using this product, it is important that you read and understand the content of these installation and operating instructions. The installation instructions will guide you through the possibilities with the Swing Away Series.

Instructions are written with the expressed intent of use with standard configurations. They also contain important safety and maintenance information. For further assistance, or more advanced applications, please contact your supplier or Stealth Products at (512) 715-9995 or toll free at 1-800-965-9229.

Always keep the operating instructions in a safe place so they may be referenced as necessary.

All information, pictures, illustrations, and specifications are based on the product information that was available at the time of printing. Pictures and illustrations shown in these instructions are representative examples and are not intended to be exact depictions of the various parts of the product.

Ordering Documentation

You can download additional copies of this User Manual on the Stealth website:

<https://stlpro.site/stealth-docs>

and search: *SUS9 Swing Away Series User Manual* in the search bar at the top of the page.

Our products are designed, manufactured, and produced to the highest of standards. If any defect in material or workmanship is found, Stealth Products will repair or replace the product at our discretion. Any implied warranty, including the implied warranties of merchantability and fitness for a particular purpose, shall not extend beyond the duration of this warranty. Stealth Products, LLC does not warrant damage due to, but not limited to:

- Misuse, abuse, or misapplication of products.
- Modification or product without written approval from Stealth Products, LLC.
- Any alteration or lack of serial number, where applicable, will automatically void this warranty.
- Stealth Products, LLC is liable for replacement parts only.
- Stealth Products, LLC is not liable for any incurred labor costs.

No person is authorized to alter, extend, or waive the warranties of Stealth Products, LLC.

Stealth Products warrants against failure due to defective materials or workmanship:

Covers: 2 years

Hardware: 5 years

Electronics: 3 years

In Case of Product Failure

In the event of product failure covered by our warranty, please follow the procedures outlined below:



1. Call Stealth at +1 (512) 715-9995 or toll free +1-800-965-9229.
2. Request the Returns Department or obtain an RA from the Returns Department and follow department or documentation instructions.

1.0 Customer Satisfaction	i
2.0 Important Information	ii
3.0 Introduction	iii
4.0 Warranty	iv
5.0 Table of Contents	v
6.0 Warning Labels	vi
6.1 Warning Labels	vi
6.2 Limited Liability	vi
6.3 Testing	vi
7.0 Parts and Accessories	vii
7.1 Parts Included	vii
8.0 Installation Instructions	1
8.1 Installing the Mounting Hardware	1
8.2 Installing Hardware onto Chair Hardware	1
9.0 Mounting	3
9.1 Mounting Accessories	3
10.0 Testing	4
10.1 Check that the SUS9	4
10.2 Operational Test	4
11.0 First Time Use	5
11.1 Dealer Assistance	5
11.2 User Testing	5
11.3 Conditions of Use	5
12.0 Maintenance	6
12.1 Cleaning	6
12.2 Monthly	6

Warning Labels

6.1

Warnings are included for the safety of the user, client, operator and property. Please read and understand what the signal words **SAFETY**, **NOTICE**, **CAUTION**, **WARNING** and **DANGER** mean, how they could affect the user, those around the user, and property.

 DANGER	Identifies an imminent situation which (if not avoided) will result in severe injury, death, and property damage .
 WARNING	Identifies a potential situation which (if not avoided) will result in severe injury, death, and property damage .
 CAUTION	Identifies a potential situation which (if not avoided) will result in minor to moderate injury, and property damage .
NOTICE	Identifies important information not related to injury, but possible property damage .
SAFETY	Indicates steps or instructions for safe practices, reminders of safe procedures, or important safety equipment that may be necessary.

Limited Liability

6.2

Stealth Products, LLC accepts no liability for personal injury or damage to property that may arise from the failure of the user or other persons to follow the recommendations, warnings, and instructions in this manual.

Testing

6.3

Initial setup and driving should be done in an open area free of obstacles until the user is fully capable of driving safely.

The SUS9 Swing Away should always be tested without any person sitting in the wheelchair until every alteration of the physical installation or adjustment is complete.

Parts Included

7.1

- 10-24 x 1/2" screws, 6 included
 - Shoulder Bolt Screws, 2 included
 - Shoulder Bolt Nuts, 2 included
- SU260, 2 included
 - SUS9-E, 2 included
 - SUS, 1 included

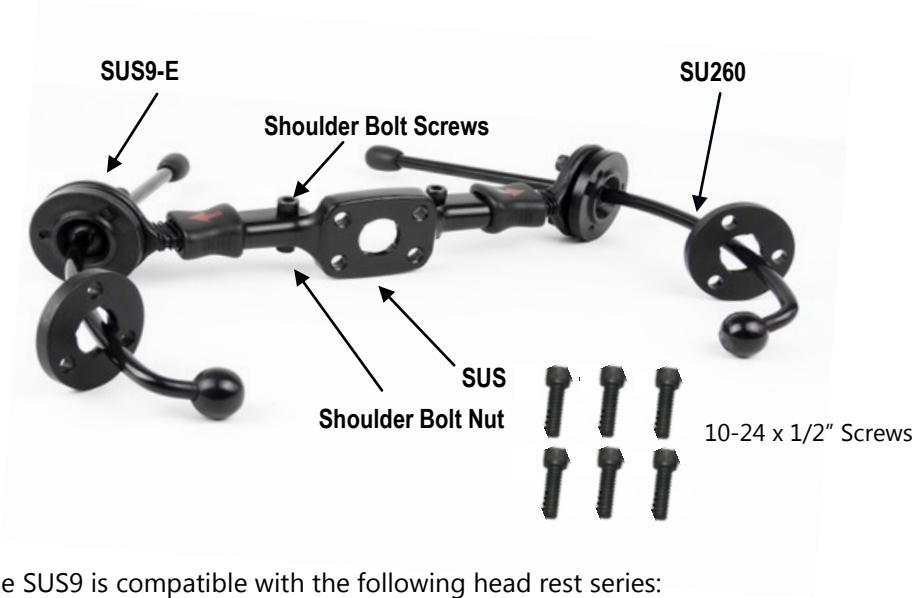

The SUS9 is compatible with the following head rest series:

- All Positioning
- Combo
- Stealth Ultra
- i2i

Single, Pediatric, and Dual swing-away options are available with the SUS9 series.

Available rod lengths for the SUS9 include:

SU262	SU260	SU264	SU264	SU266
6 inch	9 inch	13 inch	18 inch	24 inch

Installing the Mounting Hardware

8.1

1. Attach swing away ear pieces (SUS9-E) into designated cut out on the center mounting bracket (SUS).
2. Insert shoulder bolt screws through designated hole, attaching the shoulder bolt nuts and tighten until secure.
3. Adjust socket head screws on ear piece so that the slotted ball expands.
4. Slide facial lateral rods (SU260) through the slotted balls.
5. Adjust rods to desired position and tighten socket head screws.

Installing Hardware onto Chair Hardware

8.2

1. Remove the tapered set screw from ball receiver and remove the 17mm steel ball.

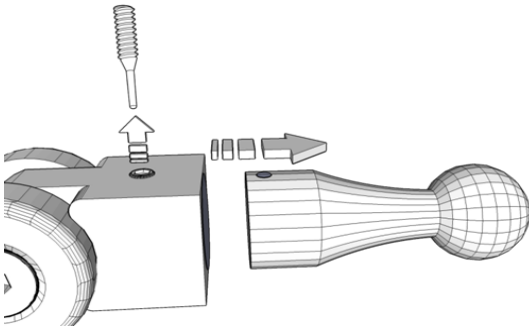

2. Slide backside of ball through SUS center swing away mounting bracket.

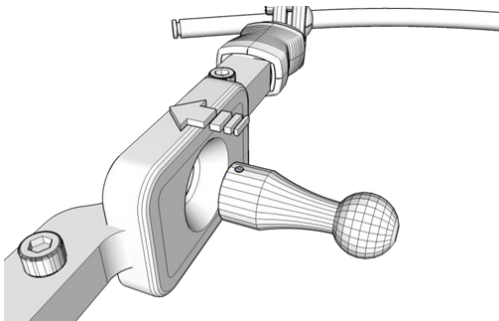

3. Slide 17mm steel ball with swing away hardware back into ball receiver. Retighten tapered set screw with 5/32 T-Handle in a clockwise direction.
4. Insert 10-24x 1/2" Socket Head Screws through SUS bracket and into designated threaded holes of headrest bracket.

⚠ WARNING

Do not overtighten screws.

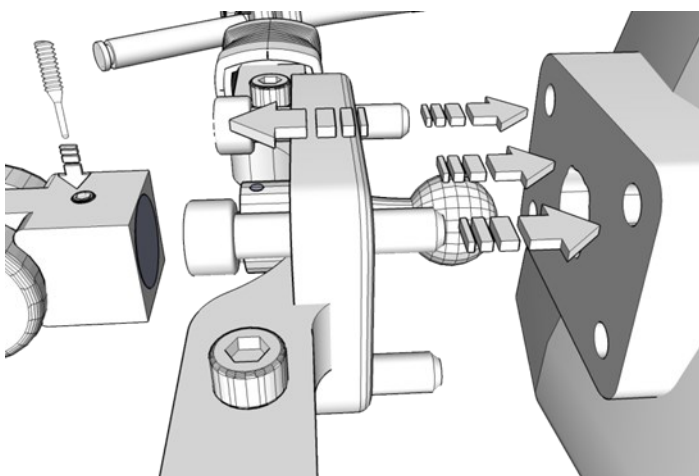

5. Tighten all screws evenly with a 5/32 T-Handle in a clockwise direction.

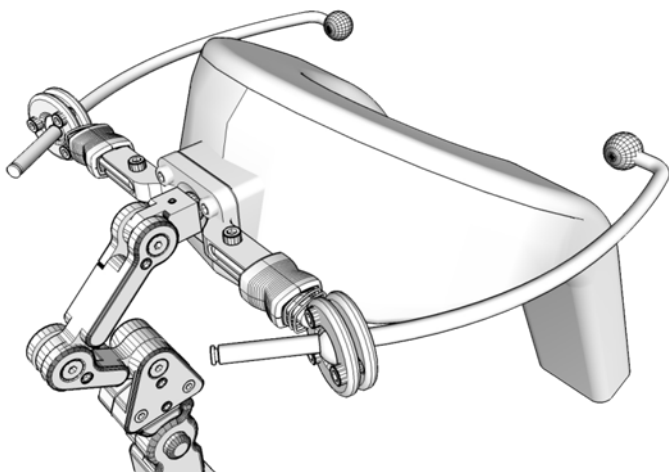

Mounting Accessories

9.1

The SUS9 Swing Away system was designed for mounting facial pads, switches, or drive controls. The unique design allows for a 5/32 T-Handle adjust and assemble. To mount accessories to the swing away system:

1. After the swing away system has been mounted to the headrest, loosen the 10-24x 1/2" Socket Head Screws on ear pieces and slide lateral rods with accessory mounting ring into desired position.

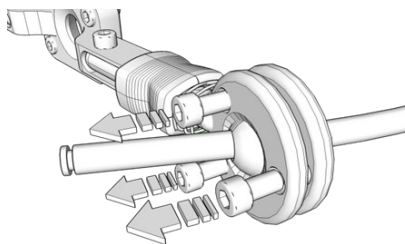

2. Slide accessory mounting ring until it fits around the lateral rod ball. Insert 10-24 x 1/2" Socket Head Screws through drilled out hold pattern and into the threaded holes of facial pad/switches. Tighten all screws evenly with a 5/32 T-Handle in a clockwise direction.

NOTICE

Facial pads/switches can be mounted to swing away lateral rods. Lateral rods come with specific mounting rings to attach pads/switches.

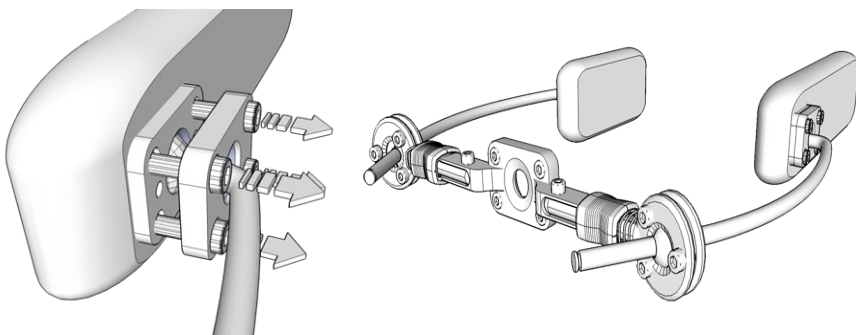

NOTICE

A 930 facial pad is shown above which requires a "rectangular ring". The 900, 910 and 920 facial pads require a "circular ring".

After installation of the swing away system, execute the following tests before the wheelchair is delivered or put into service:

- Check the SUS9 for intactness
- Operational Test

Check that the SUS9

10.1

- Is not bent or damaged.
- Housing and accessories are not damaged.
- Returns to the correct position when necessary.

Operational Test

10.2

1. Install swing away system correctly.
2. Ensure that the client is properly aligned and that seatbelts are fastened.
3. Test swing away arms to ensure they are properly moving in the correct direction.

Dealer Assistance

11.1

During first time use by the client, it is advised that the dealer or service technician assists and explains the configurations to the customer (the user and/or the attendant). If needed, the dealer can make final adjustments.

User Testing

11.2

It is important that the customer is fully aware of the installation, how to use it, and what can be adjusted in order to gain as much mobility as possible. As a dealer, proceed as follows:

- Explain and show the customer how you have executed the installation, and explain the function of every item.

Have the user test the swing away system:

- Is the hardware in the proper position for the client?
- Can the user safely operate the wheelchair with minimal effort?
- Is the placement of the SUS9 in an optimal position for the user?

If needed, adjust the swing away system to the proper position.

Explain to the customer possible problems and how to address them.

Conditions of Use

11.3

The SUS9 is intended for use as installed by the dealer, in accordance to the installation instructions in this manual.

- The foreseen conditions of use are communicated by the dealer or service technician to the user and/or attendant during first time use.
- If the usage conditions change significantly, please contact your dealer or a qualified service technician to avoid excessive wear and tear or unintended damage.

Cleaning

12.1

- To wash the facial pad cover, remove the cover from the pad, machine wash in cold water on delicate cycle and drip dry.

 **CAUTION**

Do not put foam in the dryer.

Monthly

12.2

- Check the hardware for loose screws or worn parts. Replace or repair parts as needed.
- Check facial lateral pads for any foam breakdown and/or metal coming through the foam. This could be potentially dangerous for the client.

 **DANGER**

Failure to comply with these warnings could result in serious bodily harm.



Stealth Products, LLC. • info@stealthproducts.com • www.stealthproducts.com
+1(800) 965-9229 | +1(512) 715-9995 | 104 John Kelly Drive, Burnet TX 78611